

# Stainless Steel Ball Valves

Two-Piece Body • Conventional Port • Blowout-Proof Stem •  
316 SS Trim • Cast Mounting Pad • Vented Ball

**2000 PSI/138 Bar Non-Shock Cold Working Pressure**

CONFORMS TO MSS SP-110

## MATERIAL LIST

PART	SPECIFICATION
1. Handle Nut	Stainless Steel ASTM A 276 Type 304
2. Stem	Stainless Steel ASTM A 276 Type 316
3. Lock Washer	Stainless Steel 304 SS
4. Threaded Pack Gland	Stainless Steel ASTM A 276 Type 316
5. Thrust Washer	Carbon Filled PTFE
6. Gasket	PTFE
7. Body End Piece	Stainless Steel ASTM A 351 Type CF8M
8. Ball (Vented)	Stainless Steel ASTM A 276 Type 316 or ASTM A 351 Type CF8M
9. Seat (2)	Reinforced PTFE
10. Body	Stainless Steel ASTM A 351 Type CF8M
11. Stem Packing (2)	Carbon Filled PTFE
12. Locking Handle	Stainless Steel ASTM A 240 Type 304

**NOTE:** Valves are static grounded by thrust washer and packing.  
Valves tested in accordance with ASME B16.34



**T-580-S6-R-66-LL**

Threaded

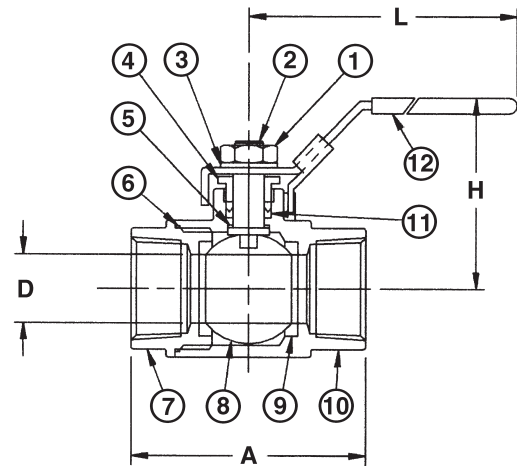

**T-580-S6-R-66-LL**  
NPT x NPT

## DIMENSIONS—WEIGHTS—QUANTITIES

Size	Dimensions						T-580-S6-R-66-LL		Master Ctn. Qty.
	A	B		D	L	H	Lbs.	Kg.	
In. mm.	In. mm.	In. mm.	In. mm.	In. mm.	In. mm.	In. mm.			
1/4 8	2.07 53	.83 21	.37 9	1.76 45	4.33 110	.51 13	.23		10
3/8 10	2.07 53	.83 21	.37 9	1.76 45	4.33 110	.48 12	.22		10
1/2 15	2.34 59	1.06 27	.50 13	1.92 49	4.33 110	.66 17	.30		10
3/4 20	2.80 71	1.34 34	.69 18	2.40 61	5.83 148	1.30 33	.59		10
1 25	3.23 82	1.61 41	.87 22	2.56 65	5.83 148	1.79 44	.81		10
1 1/4 32	3.57 91	1.89 48	1.00 25	2.74 70	7.76 197	2.52 61	1.14		5
1 1/2 40	4.04 103	2.26 57	1.25 32	2.98 76	7.76 197	3.75 104	1.70		5
2 50	4.63 118	2.76 70	1.50 38	3.17 81	7.76 197	5.80 163	2.63		5

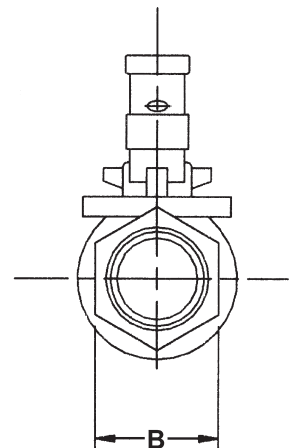

◆For detailed Operating Pressure, refer to Pressure Temperature Chart on pages 66 and 67.