

# Class 150 Stainless Steel Flanged Ball Valves

Unibody Design • Blowout-Proof Stem • 316 SS Trim • Mounting Pad • Fire Safe • Vented Ball

## 275 PSI/19 Bar Non-Shock Cold Working Pressure

CONFORMS TO ASME/ANSI B16.34, B16.5, MSS SP 72,  
API 607 FOURTH EDITION, API 608, API 598,  
MSS SP 25

### MATERIAL LIST

PART	SPECIFICATION
1. Body and End Piece	Stainless Steel ASTM A 351 Type CF8M
2. Ball (Vented)	Stainless Steel ASTM A 351 Type CF8M
3. Stem	Stainless Steel ASTM A 276 Type 316
4. Seat	Reinforced PTFE
5. Packing Set	Graphite and Braided Graphite
6. Pack Gland	Stainless Steel 304 SS
7. Pack Gland Nut	Stainless Steel
8. O-Ring	Fluorocarbon Encapsulated
9. Gasket	304 SS/Graphite Spiral Wound

† Cast specifications shown. Smaller sizes may be manufactured from equivalent bar stock specifications.

### DIMENSIONS—WEIGHTS—QUANTITIES

Size	Dimensions											
	A	B	C	D	E	F						
In. mm.	In. mm.	In. mm.	In. mm.	In. mm.	In. mm.	In. mm.	In. mm.	In. mm.	In. mm.	In. mm.	In. mm.	In. mm.
1/2	15 4.25	108 2.13	54 .47	12 3.56	90 .50	13 .43	11					
3/4	20 4.63	118 2.31	50 .47	12 3.94	100 .75	19 .63	16					
1	25 5.00	127 2.50	54 .47	12 4.31	109 1.00	25 .81	21					
1 1/2	40 6.50	165 3.25	83 .56	14 5.00	127 1.50	38 1.19	30					
2	50 7.00	178 3.00	76 .62	16 6.00	132 2.00	51 1.50	38					
3	80 8.00	203 4.00	102 .75	19 7.50	191 3.00	76 2.38	60					
4	100 9.00	229 4.25	108 .94	24 9.00	229 4.00	102 3.00	76					
6	150 10.50	267 5.25	133 1.00	25 11.00	279 6.00	152 4.38	111					
8	200 11.50	297 5.50	140 1.13	29 13.50	343 8.00	203 5.68	144					
10	250 13.00	330 6.50	165 1.19	30 16.00	406 10.00	254 7.50	190					
12	300 14.00	356 7.38	187 1.25	32 19.00	483 12.00	305 9.50	241					

Size	Dimensions												F-510-S6-R-66-FS	
	G	H	I	J	K	L	M	N	O	P	Lbs.	Kg.		
In. mm.	In. mm.	In. mm.	In. mm.	In. mm.	In. mm.	In. mm.	In. mm.	In. mm.	In. mm.	In. mm.				
1/2	15 6.63	168 2.84	72 3.16	80 2.56	65 .59	15 .25	6 1.68	43 .250-20	1.19	30 1.19	30	3.00	1.36	
3/4	20 6.63	168 3.20	81 3.58	91 2.56	65 .76	19 .25	6 1.68	43 .250-20	1.19	30 1.19	30	5.00	2.27	
1	25 6.63	168 3.45	88 3.83	97 2.56	65 .93	24 .31	8 1.68	43 .250-20	1.19	30 1.19	30	6.00	2.72	
1 1/2	40 9.13	232 4.75	121 5.25	133 3.31	84 1.22	31 .56	14 2.06	52 .250-20	1.46	37 1.46	37	13.00	5.91	
2	50 9.13	232 4.88	124 5.38	137 3.31	84 1.36	35 .56	14 2.06	52 .250-20	1.46	37 1.46	37	17.00	7.73	
3	80 16.60	422 6.16	156 —	— —	— —	1.97	50 .68	17 3.00	76 .375-16	2.12	54 2.12	54	42.00	19.09
4	100 16.60	422 7.22	183 —	— —	— —	2.16	55 .68	17 3.00	76 .375-16	2.12	54 2.12	54	64.00	29.09
6	150 32.80	833 10.09	256 —	— —	— —	3.59	91 1.13	29 4.50	114 .500-13	3.18	81 3.18	81	126.00	57.27
8	200 —	— —	— —	— —	— —	3.43	87 1.13	29 4.50	114 .500-13	3.18	81 3.18	81	198.00	90.00
10	250 —	— —	— —	— —	— —	5.56	141 1.75	44 —	— .625-11	7.24	184 3.66	93	296.00	134.55
12	300 —	— —	— —	— —	— —	5.63	143 2.00	31 —	— .625-11	8.10	205 4.68	119	477.00	216.82

Note: Valves are static grounded by thrust washer.

◆ For detailed Operating Pressure, refer to Pressure Temperature Chart on page 81.

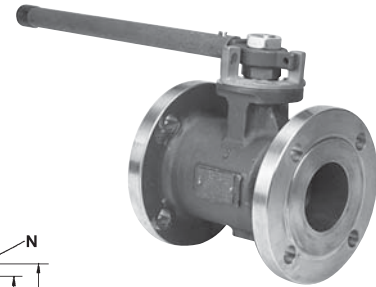

**F-510-S6-R-66-FS**  
Stainless x Stainless  
Flanged

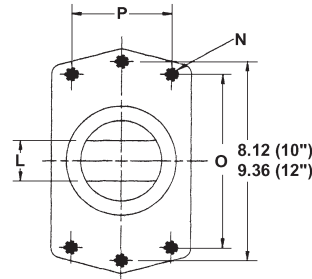

TOP FLANGE FOR  
10" & 12"

STOP PLATE  
REMOVABLE  
FOR ACTUATION

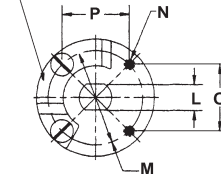

TOP FLANGE FOR  
3" THRU 8"

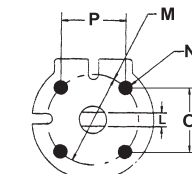

TOP FLANGE FOR  
1/2" THRU 2"

