

Class 150 Carbon Steel Flanged Ball Valves

Unibody Design • Blowout-Proof Stem • 316 SS Trim • Mounting Pad • Fire Safe • Vented Ball

285 PSI/19.7 Bar Non-Shock Cold Working Pressure

CONFORMS TO ASME/ANSI B16.34, B16.5, MSS SP 72,
API 607 FOURTH EDITION, API 608, API 598,
MSS SP 25

MATERIAL LIST

| PART | SPECIFICATION |
|-----------------------|--------------------------------------|
| 1. Body and End Piece | Carbon Steel ASTM A 216 Type WCB |
| 2. Ball (Vented) | Stainless Steel ASTM A 351 Type CF8M |
| 3. Stem | Stainless Steel ASTM A 276 Type 316 |
| 4. Seat | Reinforced PTFE |
| 5. Packing Set | Graphite and Braided Graphite |
| 6. Pack Gland | Stainless Steel 304 SS |
| 7. Pack Gland Nut | Carbon Steel Plated |
| 8. O-Ring | Fluorocarbon Encapsulated |
| 9. Gasket | 304 SS/Graphite Spiral Wound |

¹ Cast specifications shown. Smaller sizes may be manufactured from equivalent bar stock specifications.

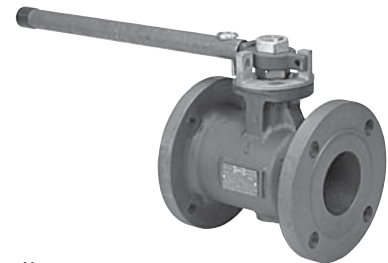

F-510-CS-R-66-FS
Carbon x Stainless
Flanged

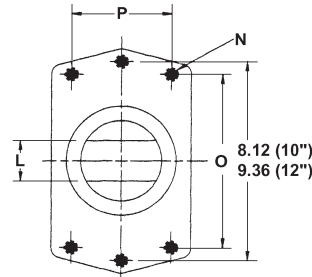

TOP FLANGE FOR
10" & 12"

STOP PLATE
REMOVEABLE
FOR ACTUATION

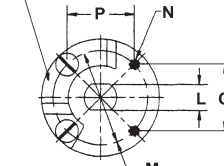

TOP FLANGE FOR
3" THRU 8"

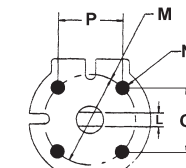

TOP FLANGE FOR
1/2" THRU 2"

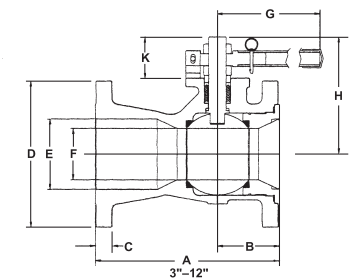
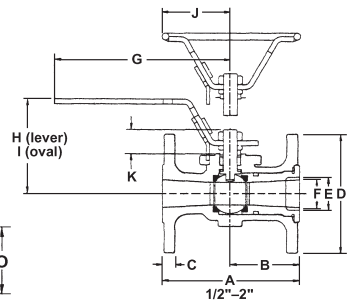

DIMENSIONS—WEIGHTS—QUANTITIES

| Size | Dimensions | | | | | | | | | | | | |
|---------|------------|---------|---------|---------|---------|---------|---------|---------|---------|---------|---------|---------|-----|
| | A | | B | | C | | D | | E | | F | | |
| In. mm. | In. mm. | In. mm. | In. mm. | In. mm. | In. mm. | In. mm. | In. mm. | In. mm. | In. mm. | In. mm. | In. mm. | In. mm. | |
| 1/2 | 15 | 4.25 | 108 | 2.13 | 54 | .47 | 12 | 3.56 | 90 | .50 | 13 | .43 | 11 |
| 3/4 | 20 | 4.63 | 118 | 2.31 | 50 | .47 | 12 | 3.94 | 100 | .75 | 19 | .63 | 16 |
| 1 | 25 | 5.00 | 127 | 2.50 | 54 | .47 | 12 | 4.31 | 109 | 1.00 | 25 | .81 | 21 |
| 1 1/2 | 40 | 6.50 | 165 | 3.25 | 83 | .56 | 14 | 5.00 | 127 | 1.50 | 38 | 1.19 | 30 |
| 2 | 50 | 7.00 | 178 | 3.00 | 76 | .62 | 16 | 6.00 | 132 | 2.00 | 51 | 1.50 | 38 |
| 3 | 80 | 8.00 | 203 | 4.00 | 102 | .75 | 19 | 7.50 | 191 | 3.00 | 76 | 2.38 | 60 |
| 4 | 100 | 9.00 | 229 | 4.25 | 108 | .94 | 24 | 9.00 | 229 | 4.00 | 102 | 3.00 | 76 |
| 6 | 150 | 10.50 | 267 | 5.25 | 133 | 1.00 | 25 | 11.00 | 279 | 6.00 | 152 | 4.38 | 111 |
| 8 | 200 | 11.50 | 297 | 5.50 | 140 | 1.13 | 29 | 13.50 | 343 | 8.00 | 203 | 5.68 | 144 |
| 10 | 250 | 13.00 | 330 | 6.50 | 165 | 1.19 | 30 | 16.00 | 406 | 10.00 | 254 | 7.50 | 190 |
| 12 | 300 | 14.00 | 356 | 7.38 | 187 | 1.25 | 32 | 19.00 | 483 | 12.00 | 305 | 9.50 | 241 |

| Size | Dimensions | | | | | | | | | | | | F-510-CS-R-66-FS | | | | | | | | | |
|---------|------------|---------|---------|---------|---------|---------|---------|---------|---------|---------|------|------|------------------|------|-----|---------|------|-----|------|-----|--------|--------|
| | G | H | I | J | K | L | M | N | O | P | Lbs. | Kg. | | | | | | | | | | |
| In. mm. | In. mm. | In. mm. | In. mm. | In. mm. | In. mm. | In. mm. | In. mm. | In. mm. | In. mm. | In. mm. | | | | | | | | | | | | |
| 1/2 | 15 | 6.63 | 168 | 2.84 | 72 | 3.16 | 80 | 2.56 | 65 | .59 | 15 | .25 | 6 | 1.68 | 43 | .250-20 | 1.19 | 30 | 1.19 | 30 | 3.00 | 1.36 |
| 3/4 | 20 | 6.63 | 168 | 3.20 | 81 | 3.58 | 91 | 2.56 | 65 | .76 | 19 | .25 | 6 | 1.68 | 43 | .250-20 | 1.19 | 30 | 1.19 | 30 | 5.00 | 2.27 |
| 1 | 25 | 6.63 | 168 | 3.45 | 88 | 3.83 | 97 | 2.56 | 65 | .93 | 24 | .31 | 8 | 1.68 | 43 | .250-20 | 1.19 | 30 | 1.19 | 30 | 6.00 | 2.72 |
| 1 1/2 | 40 | 9.13 | 232 | 4.75 | 121 | 5.25 | 133 | 3.31 | 84 | 1.22 | 31 | .56 | 14 | 2.06 | 52 | .250-20 | 1.46 | 37 | 1.46 | 37 | 13.00 | 5.91 |
| 2 | 50 | 9.13 | 232 | 4.88 | 124 | 5.38 | 137 | 3.31 | 84 | 1.36 | 35 | .56 | 14 | 2.06 | 52 | .250-20 | 1.46 | 37 | 1.46 | 37 | 17.00 | 7.73 |
| 3 | 80 | 16.60 | 422 | 6.16 | 156 | — | — | — | — | 1.97 | 50 | .68 | 17 | 3.00 | 76 | .375-16 | 2.12 | 54 | 2.12 | 54 | 42.00 | 19.09 |
| 4 | 100 | 16.60 | 422 | 7.22 | 183 | — | — | — | — | 2.16 | 55 | .68 | 17 | 3.00 | 76 | .375-16 | 2.12 | 54 | 2.12 | 54 | 64.00 | 29.09 |
| 6 | 150 | 32.80 | 833 | 10.09 | 256 | — | — | — | — | 3.59 | 91 | 1.13 | 29 | 4.50 | 114 | .500-13 | 3.18 | 81 | 3.18 | 81 | 126.00 | 57.27 |
| 8 | 200 | — | — | — | — | — | — | — | — | 3.43 | 87 | 1.13 | 29 | 4.50 | 114 | .500-13 | 3.18 | 81 | 3.18 | 81 | 198.00 | 90.00 |
| 10 | 250 | — | — | — | — | — | — | — | — | 5.56 | 141 | 1.75 | 44 | — | — | .625-11 | 7.24 | 184 | 3.66 | 93 | 296.00 | 134.55 |
| 12 | 300 | — | — | — | — | — | — | — | — | 5.63 | 143 | 2.00 | 31 | — | — | .625-11 | 8.10 | 205 | 4.68 | 119 | 477.00 | 216.82 |

Note: Valves are static grounded by thrust washer.

◆ For detailed Operating Pressure, refer to Pressure Temperature Chart on page 81.